



REEL TECH

# TECHNICAL DOCUMENT

PFI 100 – Heavy Duty Hoist

## Key Features :

Lifting weight of up to 100kg

Lowering distance 20m

Safety locking device

Remote controlled

Manual key switch built in

Pre wired terminals

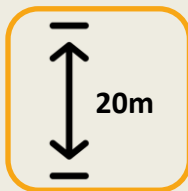

# Please note the following warnings!

Warranty is void with non-compliance!



DO NOT operate the lift without the minimum weight or the lift will fail!



DO NOT carry the lift by the cables!



DO NOT apply any external voltage to the signal control wires!

Overview:



Wiring Diagram:

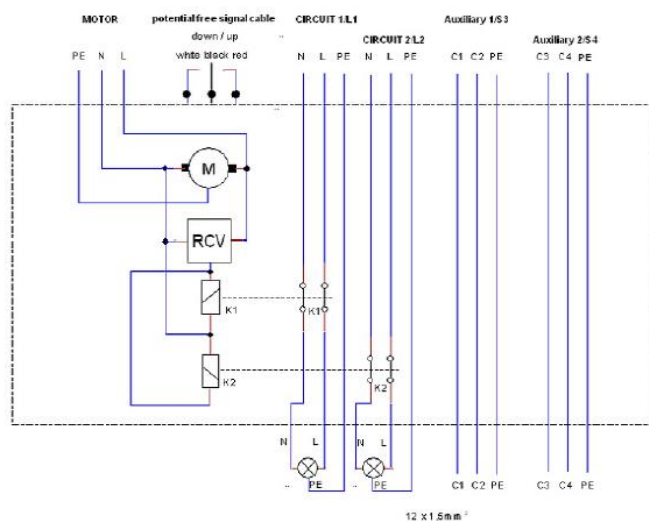

Product	PFI 100		
Rated Specification		Lowering / Raising Specification	
Type	HEAVY DUTY	Model	PFI 100
Model	PFI 100	Lifting weight of fitting	50 - 100 Kg
Option	Standard	Lowering distance (m)	20
Operating voltage	240v 50Hz	Lowering / Raising Speed	1.0/1.5 m/min
Wattage	300w	Lamp Circuit	
Dimensions	410x410x634.5mm	Model	PFI 100
Unit Net Weight	60kg	No. Of Circuits	4
Ambient Temperature	-15* to 60*	No. Of Contacts	8
Construction		Lamp Capacity	2 x 16 amp 2 x 6amp
Model	PFI 100	Certification	
Protection category	IP54	Standards ISO9001, ISO14001, ETL, CE, TUV, SAA, GOST	
Suspension Wire Dia	3.0mm		
Suspension Wire	SUS304 7x19		

## Safety Locking Device :

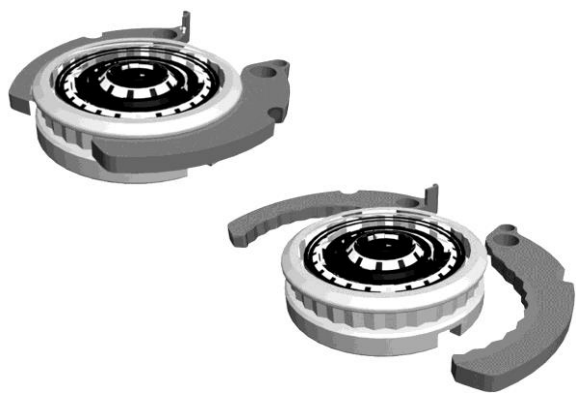

The Safety locking device provides additional security when the lift is at rest.

Special safety locking jaws engage to take the load off the suspension cables.

The jaws remain locked even in the event of a power failure and only disengage when the lift is operated.

## Electrical Contact Plates

Electrical contact is made by way of spring loaded contacts plates within the main unit and fixed contacts in the lowering coupler of the lift.

Upon lowering the lift the internal relay isolates the electrical supply, once in the raised position the relay returns power to the lower contacts

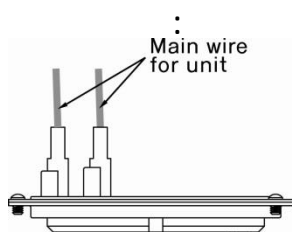

Upper part contact

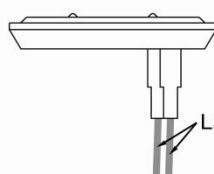

Lower part contact



## Standard mounting option : MB D

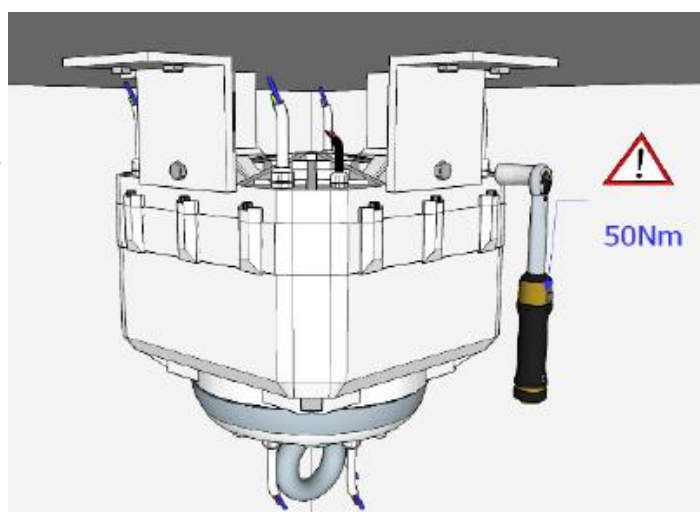
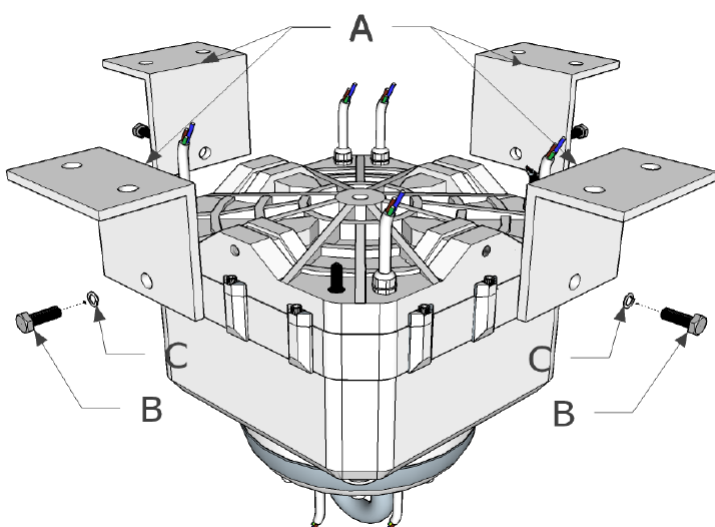

## Product Overview :

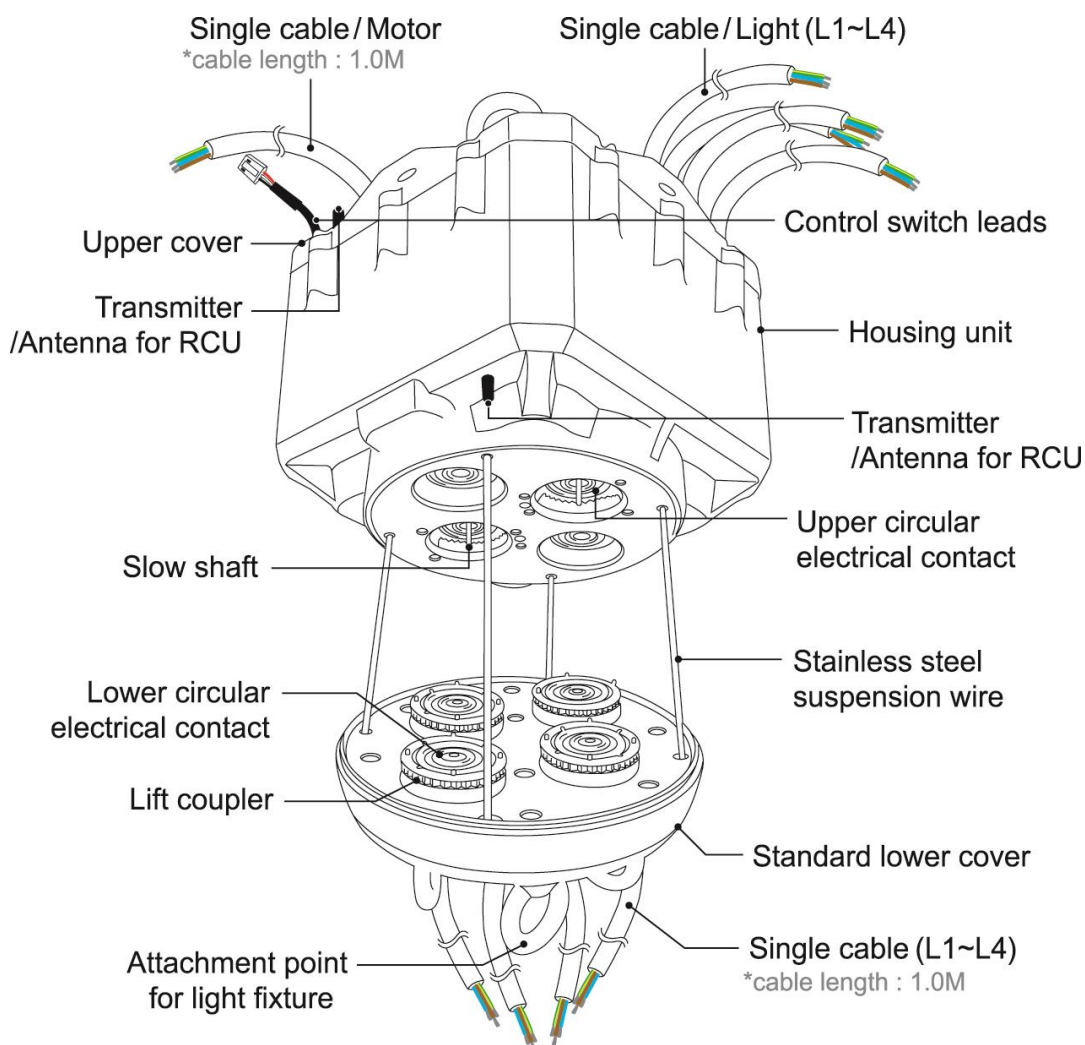

## Dimensions :

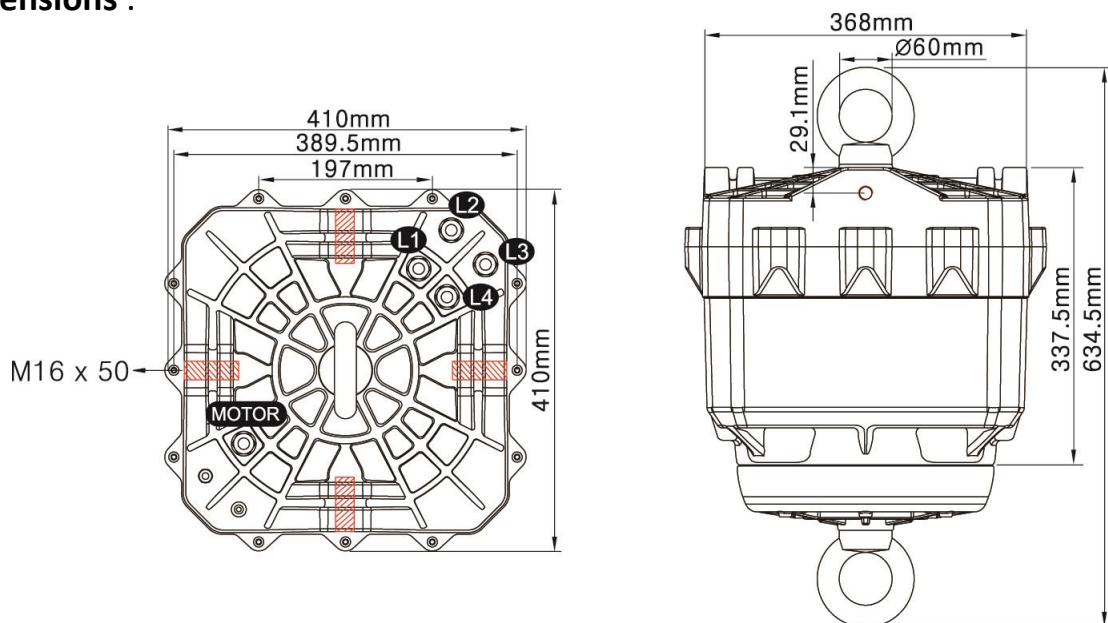





**Remote control** : or RCU can control up to 999 lift addresses

Each lift has its own integrated radio receiver with a unique serial address.

The RCU operates in the license-free ISM band of 433.92 MHz The range is circa 100 metres.

Lifts can be controlled individually, in pairs or in multiple groups.

- ① **LIGHT ON** "ON" button for Lighting
- ② **CLEAR** erase the value
- ③ **LIGHT OFF** "OFF" button for Lighting
- ④ **UP** To ascend lifter
- ⑤ **DOWN** To descend lifter
- ⑥ **4 DOWN-SET STOP** Control button for descending length
- ⑦ **5 SET** Set mode is secured by password please contact local retailer or agency
- ⑧ **7 GROUP** Group button for group functions
- ⑨ **8 CHANGE** Select switch button for unit code and serial number code.
- ⑩ **9 CHECK** To check serial number with unit code.
- ⑪ **MODE** Mode button is used in conjunction with the following buttons
- ⑫ **POWER** Power button for Remote control

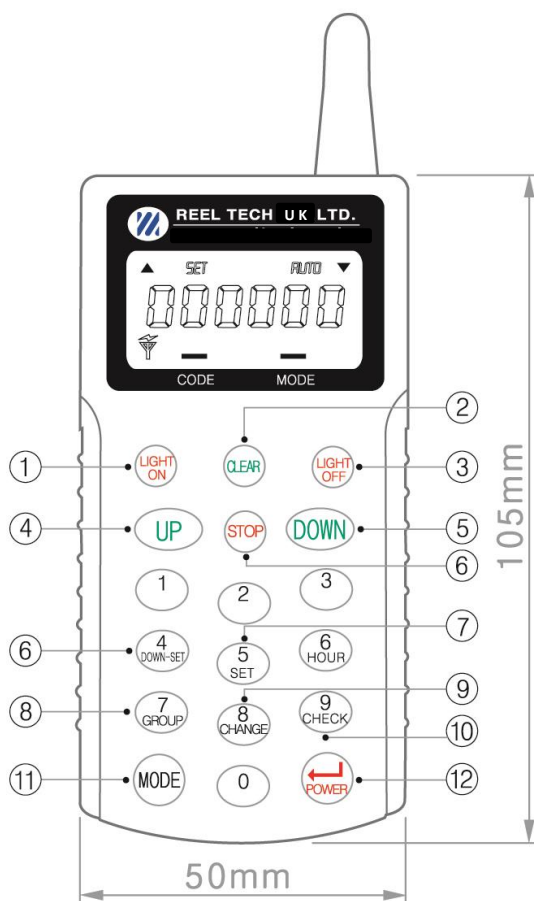

### Auto Stop Feature :

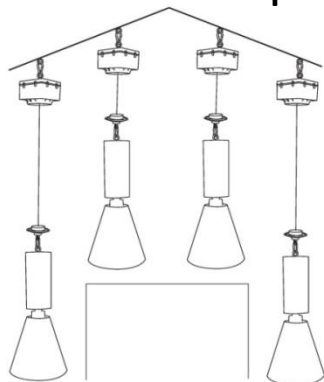

When lowering, the lift stops automatically if the decent is interrupted or when it reaches the ground.

### Adjustable Lowering Height :

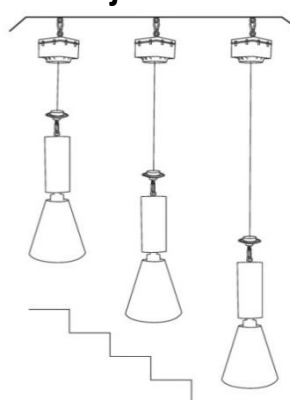

Each lift can be set to stop at the users desired lowering height. This can be stored in the lift for future operations

## Keyswitch operation example :

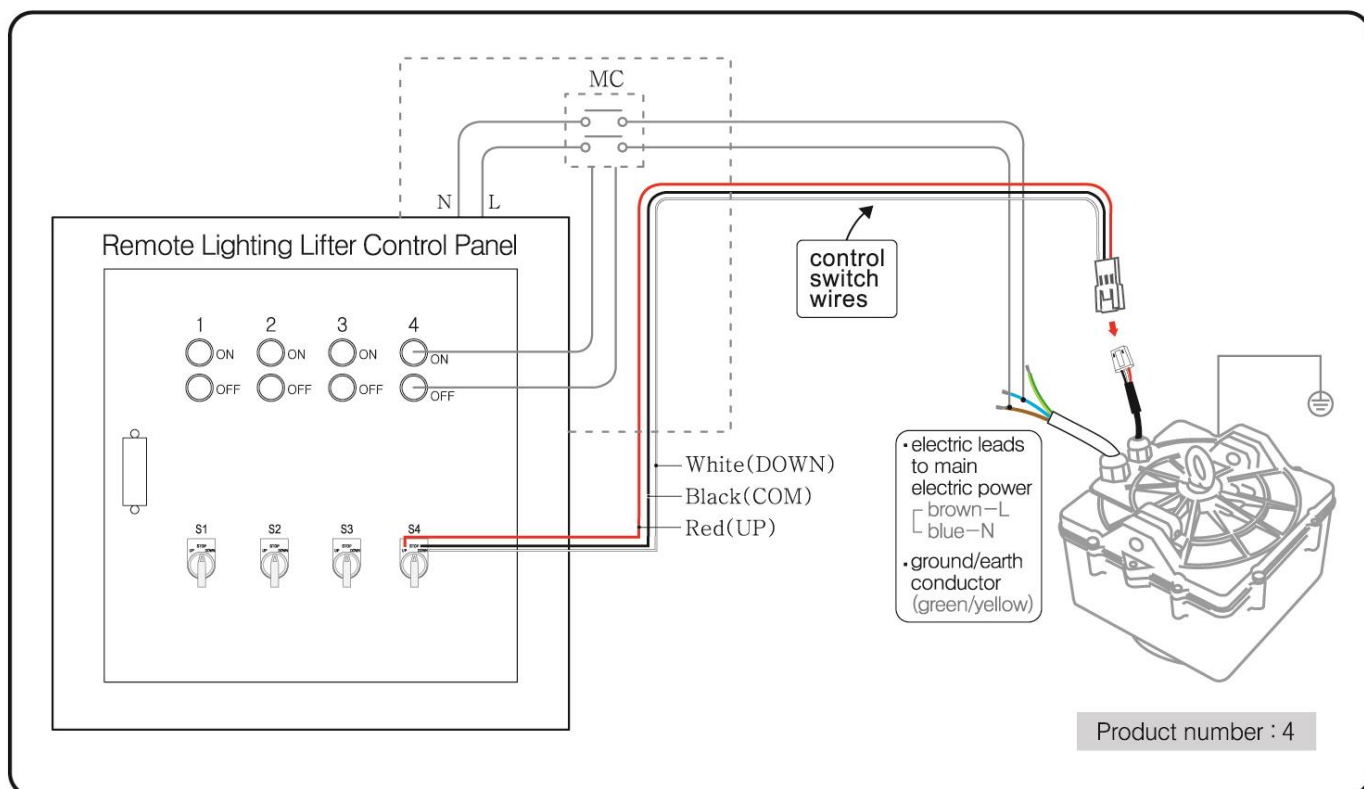

## Keyswitch Control :

Control switch **Do not connect Black+Red+White**  
Do not connect any voltage.

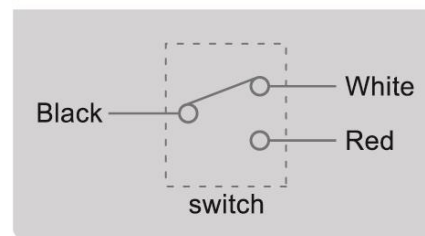
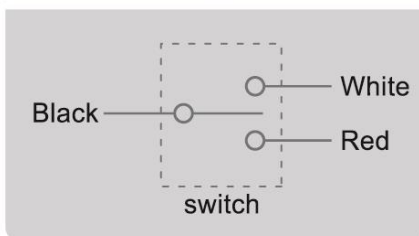
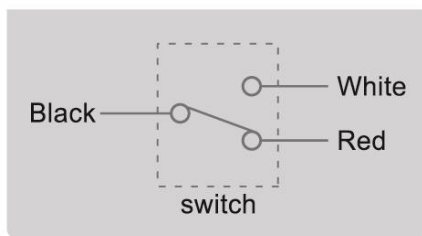
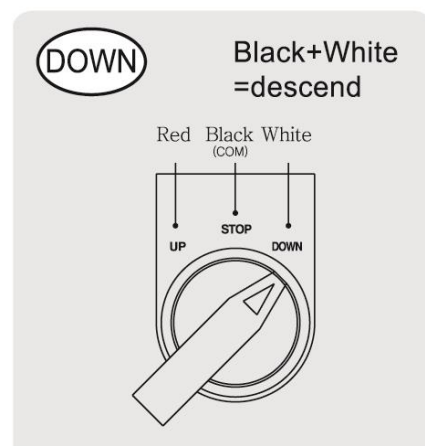
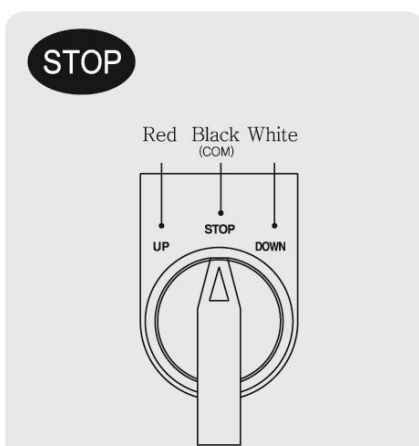
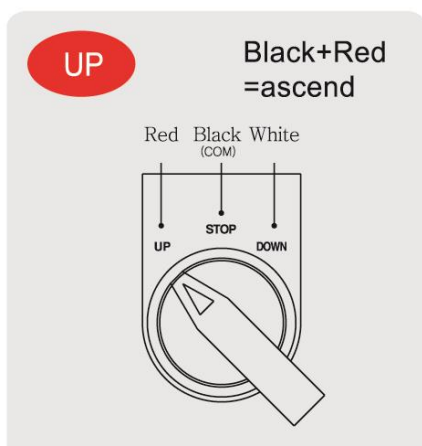

## Optional Product Accessories Examples :

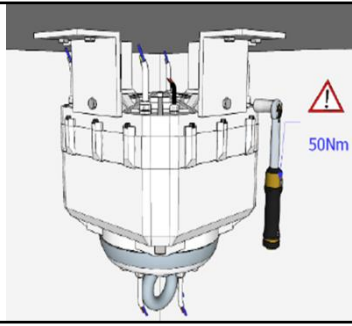
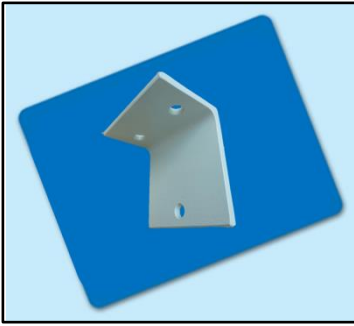

**MB D** : Used to securely mount the lift to the ceiling substrate with multiple fixing points.

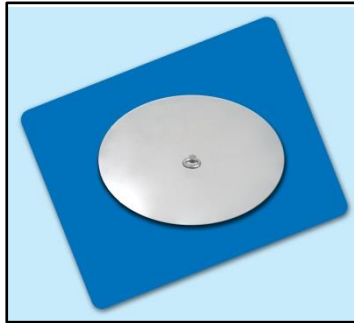

**RA C** : Used to recess the lift behind a suspended ceiling to conceal the lift from view.

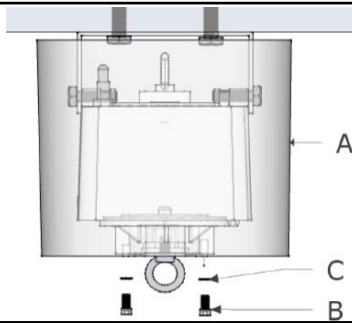
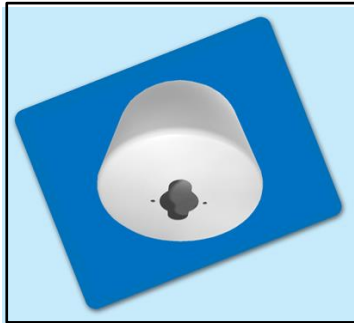

**AH D** : Used to cover surface mounted lifts, can also be painted to match ceiling colour.



**REEL TECH UK LTD**  
**Unit 1 Mere Farm Business Complex**  
**Red House Lane**  
**Hannington**  
**Northampton**  
**NN6 9SZ**  
**United Kingdom**  
**T: 01604 643522**  
**F: 01604 697028**  
**E: [enquiries@reeltechuk.com](mailto:enquiries@reeltechuk.com)**

**[www.reeltechuk.com](http://www.reeltechuk.com)**